

COMPUTER GENERATED DRAWING MANUAL CHANGES NOT AUTHORIZED		REVISIONS	
REV.	DESCRIPTION	DATE	RELEASED BY
NC	INITIAL RELEASE	3-18-93	T.R.
A	REV PER ECNI 5515		

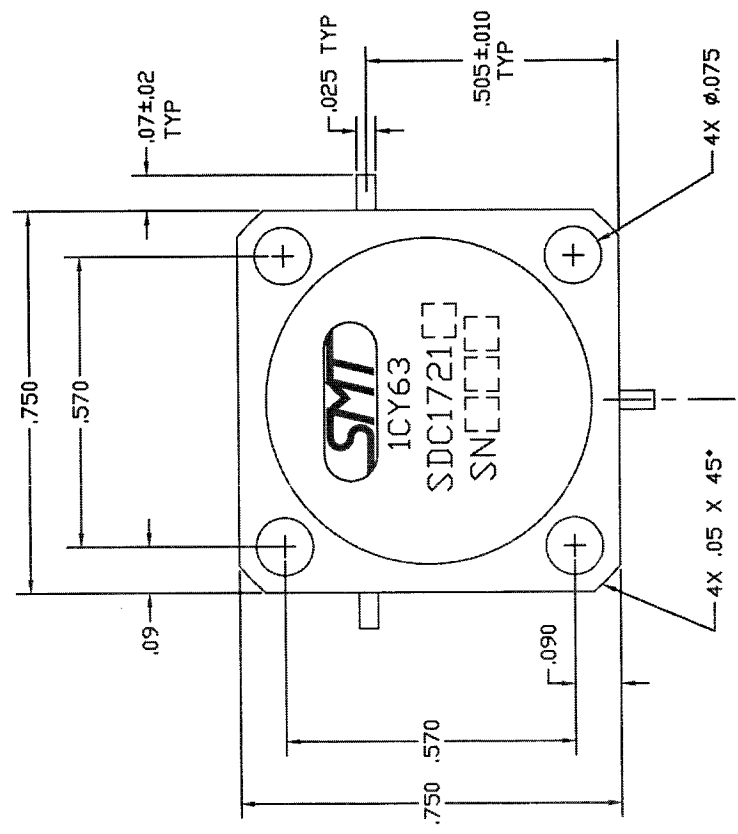
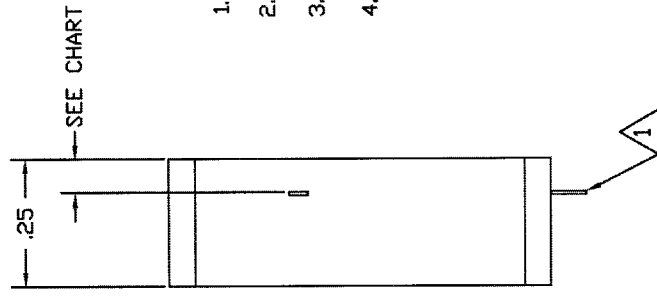

SPECIFICATIONS

- FREQUENCY RANGE _____ 1.7 TO 2.1 GHz
- VSWR _____ 1.25:1 MAX
- INSERTION LOSS _____ 0.4 dB MAX
- TEMPERATURE
 OPERATING _____ -54°C TO +100°C
 STORAGE _____ -54°C TO +100°C

TAB HEIGHT TABLE

OPTION NO.	HEIGHT (NOM.)
A	.065
B	.075
C	.090
D	.100
E	.120

ITEM	QTY	FRSCM NO.	PART OR IDENTIFICATION NO.	NUMERICAL LETTER OR DESCRIPTION	MATERIAL SPECIFICATION
PARTS LIST					
CONTRACT NO.					
APPROVALS		DATE			
NAME	A. WILSON	3-4-93			
DESIGNER	P.J.C.	3-4-93			
PREPARED BY	T.R.	3-18-93			
MATERIAL: _____					
FINISH: _____					
DO NOT SCALE DRAWING					

SIERRA MICROWAVE TECHNOLOGY	
TITLE: OUTLINE FOR SDC1721X	
SIZE	FRSCM NO.
B	1CY63
DWG NO.	REV
205-1354-001	A
SECRET	OF

3. CIRCULATION IS CLOCKWISE.
 2. CASE: STAINLESS STEEL NICKEL PLATED.
 1. TABS ARE .005±.001 THK Be Cu, SN63 SOLDER TINNED.

NOTES: